

WEST SUSSEX COUNTY COUNCIL  
((CHICHESTER DISTRICT) (PARKING PLACES & TRAFFIC REGULATION)  
(CONSOLIDATION) ORDER 2010)  
(SHERBORNE ROAD & DURNFORD CLOSE AMENDMENT) ORDER 2018

CHICHESTER: LOCATION OF WAITING RESTRICTIONS

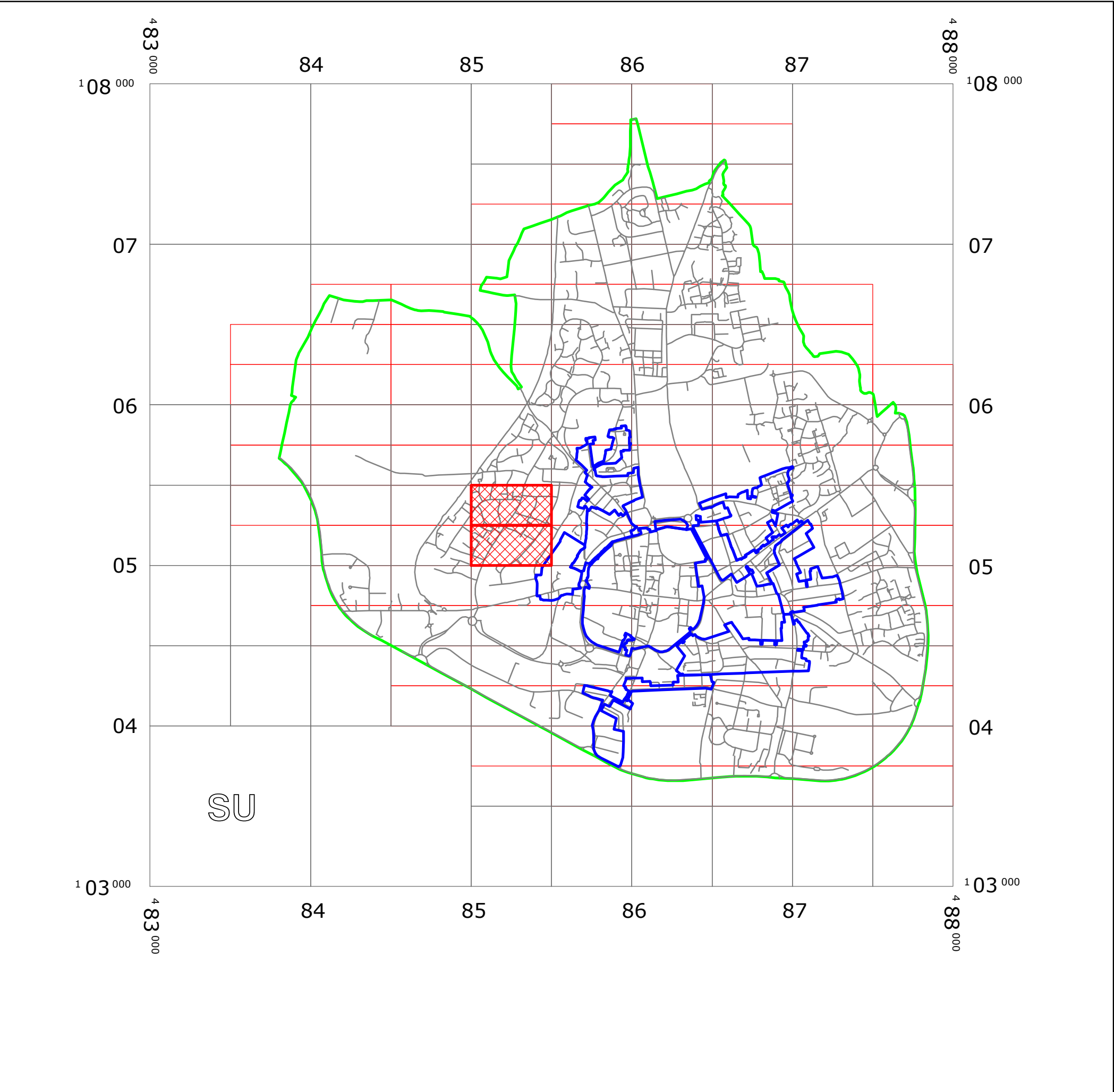

**KEY:**

OS.TILE GRID

PARKING TILE GRID

LOCATION OF WAITING RESTRICTIONS

PARISH BOUNDARY

CONTROLLED PARKING ZONE BOUNDARY

ROAD NETWORK

Key for Waiting Restrictions

All areas over which the provision of the orders apply are defined by the shaded areas as shown on the following plans plus a contiguous area not indicated on the plans of verge and/or footway between the carriageway edge and the highway boundary. The plans in this schedule are based upon grid references of the Ordnance Survey National Grid defined by the OSGB 36 triangulation.

Prohibition of waiting at any time

100



z\_circle

No waiting, loading and unloading at any time

101



check

No waiting at any time

114

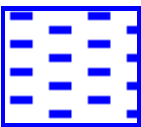

pat063

No waiting 9:00am-5:00pm Mon-Fri

Free Limited Waiting

744



herring3

Waiting limited to 2hrs No return within 1hr  
9.00am-5.00pm Mon-Fri

759

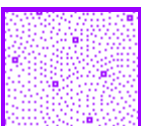

usgs601

Waiting limited to 15mins No return within 1hr  
8.00am-3.00pm Mon-Fri

Specified Vehicles

830



check

Disabled persons vehicles at any time

Clearways

1100



usgs503

School Keep Clear-No stopping at any time



Boundary of Controlled Parking Zone

**WEST SUSSEX COUNTY COUNCIL**  
**((CHICHESTER DISTRICT) (PARKING PLACES & TRAFFIC REGULATION)**  
**(CONSOLIDATION) ORDER 2010)**  
**(SHERBORNE ROAD & DURNFORD CLOSE AMENDMENT) ORDER 2018**

West Sussex County Council in exercise of their powers under Sections 1 (1) 2 (1) and (2), 4 (2), 45, 46, 49 and 53 and Part IV of Schedule 9 of the Road Traffic Regulation Act 1984 "the Act" as amended and of all other enabling powers and after consultation with the chief officer of police in accordance with Part III of Schedule 9 to the Act hereby make the following Order:-

1. This Order shall come into operation on the 12<sup>th</sup> day of February 2018 and may be cited as "West Sussex County Council ((Chichester District) (Parking Places and Traffic Regulation) (Consolidation) Order 2010) (Sherborne Road & Durnford Close Amendment) Order 2017."
2. The "West Sussex County Council (Chichester District) (Parking Places and Traffic Regulation) (Consolidation) Order 2010" is hereby amended by the deletion of the plans in the First Schedule to this Order and the substitution of the plans attached in the Second Schedule to this Order.

**FIRST SCHEDULE**  
**Plans to be deleted**

SU8505SWN (Sheet Issue No. 2)  
SU8505SWS (Sheet Issue No. 3)

**SECOND SCHEDULE**  
**Plans to be substituted**  
**(as attached)**

SU8505SWN (Sheet Issue No. 3)  
SU8505SWS (Sheet Issue No. 4)

The COMMON SEAL of WEST SUSSEX  
COUNTY COUNCIL was hereto affixed

the SIXTH day of FEBRUARY 2018  
in the presence of



Authorised Signatory

)  
)  
)  
) (L.S.)  
)  
)  
)  
)



I HEREBY CERTIFY THIS TO  
BE A TRUE COPY OF THE  
ORIGINAL DOCUMENT



.....  
Authorised Officer  
WEST SUSSEX COUNTY COUNCIL

04/18 DELEGATED AUTHORITY

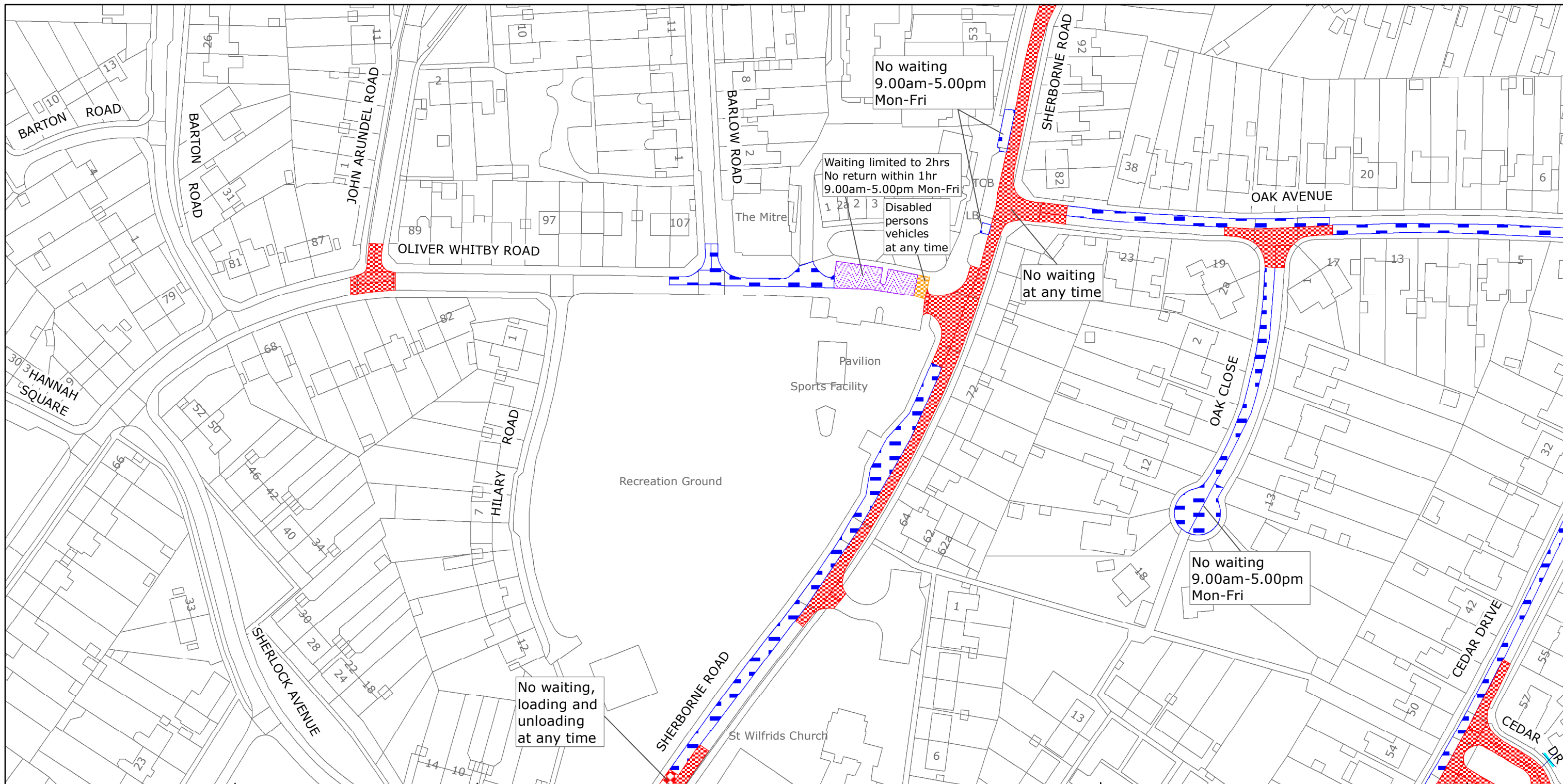

West Sussex County Council  
Highways & Transport  
The Grange  
Tower Street  
Chichester  
West Sussex  
PO19 1RH

## CHICHESTER DISTRICT: CHICHESTER

### WAITING RESTRICTIONS

Reproduced from or based upon 2018 Ordnance Survey mapping with permission of the Controller of HMSO (c) Crown Copyright reserved.  
Unauthorised reproduction infringes Crown copyright and may lead to prosecution or civil proceedings West Sussex County Council Licence No. 100018485

# TILE REF NO: SU8505SWN

SHEET ISSUE NO 3  
SHEET ACTIVE FROM - 12/02/2018



SCALE:  
1:1250  
at A3 size



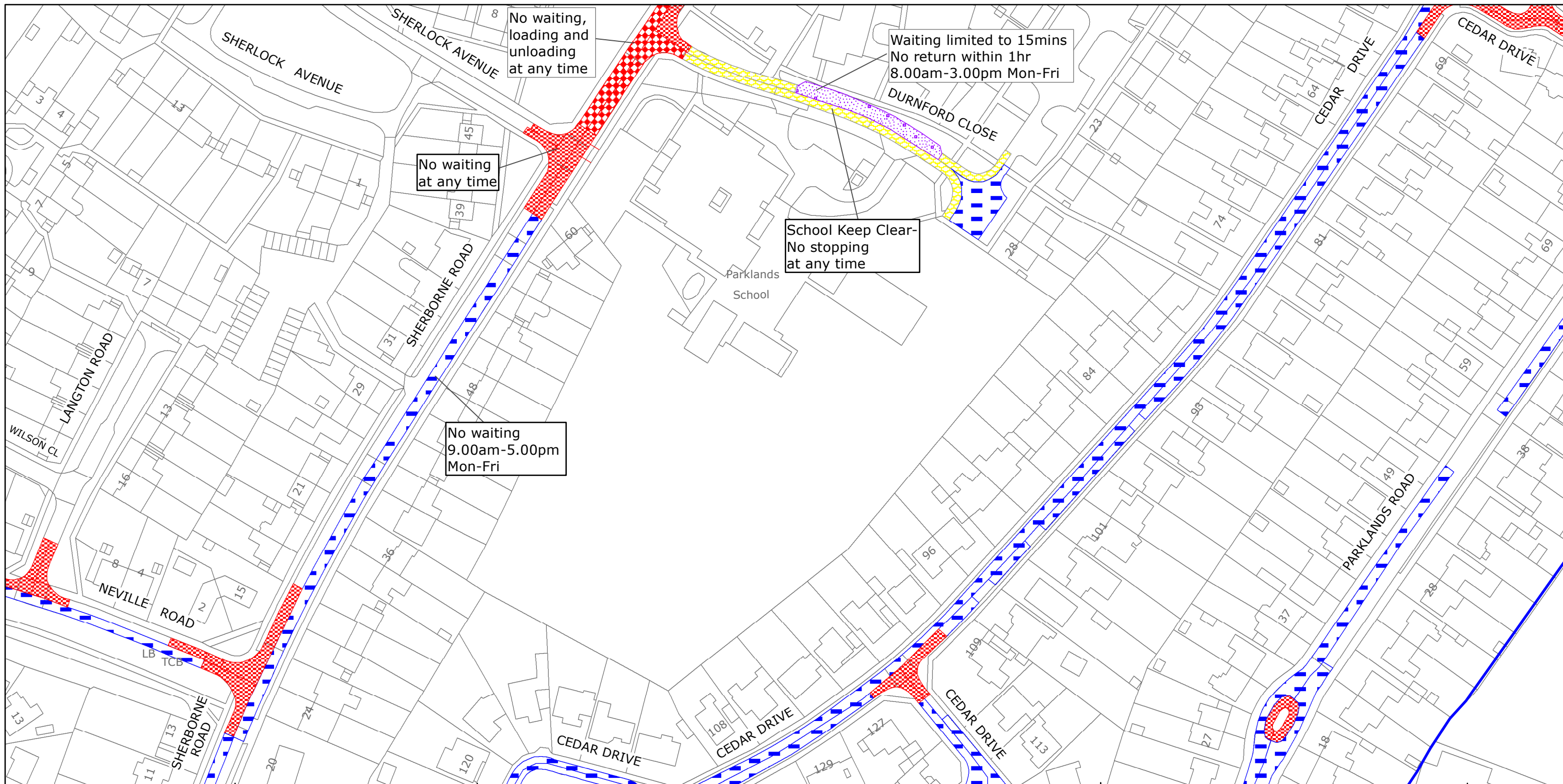

West Sussex County Council  
Highways & Transport  
The Grange  
Tower Street  
Chichester  
West Sussex  
PO19 1RH

## CHICHESTER DISTRICT: CHICHESTER

### WAITING RESTRICTIONS

Reproduced from or based upon 2018 Ordnance Survey mapping with permission of the Controller of HMSO (c) Crown Copyright reserved.  
Unauthorised reproduction infringes Crown copyright and may lead to prosecution or civil proceedings West Sussex County Council Licence No. 100018485

# TILE REF NO: SU8505SWS

SHEET ISSUE NO 4  
SHEET ACTIVE FROM - 12/02/2018



SCALE:  
1:1250  
at A3 size